

SMACIRCLE S1 - User Manual

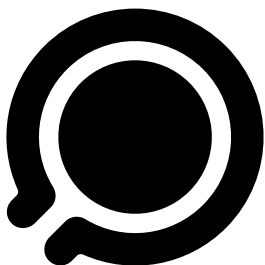

smacircleTM

HELLO!

WARNING:

- Whenever you ride the S1, you risk death or serious injury from loss of control, collisions, and falls. It is your responsibility to learn how to safely ride the S1 in order to reduce this risk. These instructions will ensure that your safety and your experience with your S1 are both optimized.
- Smacircle reserves the right to make changes to the S1, release firmware updates, and update this manual at any time. You will need to install the Smacircle App to follow the Rider Tutorial, fill in the Warranty form, watch the instruction videos and obtain the latest updates and safety instructions. In order to qualify for the One Year Complimentary Warranty, be sure to download the Smacircle APP and register your S1 before riding it for the first time.
- S1 is only for adults (not including the elderly and the disabled). One person use only. Those who suffer from hypertension, cardiovascular or other high risk disease are not suitable for the S1.
- Always wear a helmet and protective gear when riding. Use an approved bicycle or skateboard helmet that fits properly with the chin strap in place and provides protection for the back of your head. Local legislation may also require riders of two wheel products to wear a helmet and other protective gear. Never ride the Smacircle S1 barefoot, in open-toed shoes or high-heels.
- Always follow local traffic rules and road regulations.
- Before riding alone, acquaint yourself with the S1 by riding in a large, clear area with a friend as a spotter.
- Do not ride at the highest speed at the beginning of each ride, or you may risk losing control.
- Always inspect the Smacircle S1 prior to use. Properly inspecting and maintaining your product can reduce the risk of injuries and product failures.
- Avoid obstacles and slippery surfaces that could result in a loss of balance or traction and loss of control. Please slow down or dismount and push your S1 when you need to ride through poor road conditions.
- Please adjust the handlebar and seat according to your height to ensure safe riding.
- To avoid damage to the electrical parts of the vehicle, please do not immerse the Smacircle S1 in water with a depth of more than 4 cm and do not wash it with water under pressure.
- Pay attention to all Safety Warnings and Alerts from the S1. They indicate unsafe operating conditions. Understanding and responding to the S1 Safety Alerts described in the User Manual will optimize your safety.
- Never restart and ride your S1 after the battery indicator is at low due to risk of falling. You also risk damaging your battery, resulting in reduced battery life and capacity.
- While the S1 is designed to keep you moving under a variety of conditions, you should not aggressively lean into it and/or ignore the speed limit.

- Do not make any dangerous maneuvers when riding, and do not ride with only one hand.
- Do not insert the power cord if the S1 Charge Port is wet.
- Always shut down your S1 and unplug the power cord before performing any maintenance or installing any part or accessory.
- Maximum speed is 20 km/h. Please try to avoid riding at night. If needed, please limit the speed to 15 km/h or less and turn the headlights on.
- For protection, please do not ride the Smacircle S1 in bad weather such as heavy rain and/or high winds.
- Do not ride the Smacircle S1 after drinking alcohol.
- All S1 parts must be properly installed. Using your S1 without all parts properly installed could damage your S1 and result in serious injury from loss of control, collisions, and falls.
- Adhere to torque specifications when tightening slider locks. Over tightened or under tightened slider locks could malfunction, leading to damage or serious injury.
- Use only Smacircle approved parts and accessories. Do not modify the S1. Modifications to the S1 could interfere with the operation of the S1, result in serious injury and/or damage, and void the Smacircle S1 Limited Warranty.
- Smacircle S1 is not intended for use at elevations greater than 2000m above sea level.

Copyright, Trademarks, Patent, and Contact Information

Copyright ©2019 Smacircle LMT Ltd. All rights reserved.

Trademarks

Smacircle LMT Ltd. ("Smacircle") owns the Smacircle trademark that has been registered internationally. Failure of a mark to appear in this manual does not mean that Smacircle does not use the mark, nor does it mean that the product is not actively marketed or is not significant within its relevant market. Smacircle reserves all rights in its trademarks. All other trademarks are the property of their respective companies.

Patent Information

The Smacircle LMT Ltd. is covered by international patents.

Contact Information

For support, please contact the company from which you bought the product. For Smacircle detailed contact information and a listing of Authorized Smacircle Dealers and Distributors, please visit the Smacircle website at: <https://www.smacircle.com>

CONTENTS

Preface	1
About This Manual	1
The Risk of Injury	1
Before You Begin	1
Related User Materials	1
Safety Messaging	2
Product Introduction	2
Smacircle S1 Model Description	2
Smacircle S1 Specifications	3
Operating Limits	3
Maximizing Range	4
Unpacking Your Smacircle S1	4
Unfolding Your Smacircle S1	5
Folding Your Smacircle S1	16
Riding Your Smacircle S1	27
Avoiding Hazards	27
Avoiding Slips	27
Step 1: Preparing for Your Ride	28
Step 2: Powering on the Smacircle S1	28
Step 3: Riding	28
Step 4: Stopping	29
Step 5: Powering Off the Smacircle S1	29
Practice Riding	29
Turning the Lights On/Off	29
Smacircle "Power Bank"	29
Cruise Control	30
Mode Changing	30
Self-Protection Function	30
Riding Etiquette	30
Riding Tips and Safety Guidelines Recap	31
Report All Incidents	32

APP	33
What You Can Do with the Smacircle APP	33
How to Download and Open the Smacircle APP	33
Sign Up and Login	34
Activate Your Smacircle S1	35
Setup S1 Bluetooth Password	36
Smacircle S1 Battery & Charger	37
Battery Safety	37
Charging Your Battery	38
Charger Indicator Lights	38
Charger	38
Battery	38
Battery Transportation, Shipping and Disposal	38
Shipping Li-ion Battery	39
Battery Disposal	39
Maintaining Your Smacircle S1	39
Maintaining Tires and Wheels	39
Checking the Tire/Wheel Assembly	39
Cleaning Your Smacircle S1	39
Avoid Submerging Your Smacircle S1	39
Storing Your Smacircle S1	40
Smacircle S1	40
S1 Battery	40
Troubleshooting the S1	41
Contact and Legal Information	41
Report All Incidents	41
How to Reach Us	41
Laws and Regulations	41
California Energy Commission (CEC)	42
Battery Charger (BC) Mark	
FCC Statement	42
IC Statement	43
Limited Warranty	43
Warranty Information	43
Disclaimers	44

PREFACE

Congratulations on the purchase of your new Smacircle S1! The Smacircle S1 is the most innovative, lightweight and compact micro-mobility that can fit into your backpack. Smacircle S1 is your best companion for daily life.

ABOUT THIS MANUAL

To help you learn to ride your S1, we recommend that you follow the instructions and warnings in the User Manual and watch the Safety Video. Please also download the Smacircle APP which consists of videos such as Folding/Unfolding the Bike, Safety Video and more! It is important that you follow all safety warnings and cautions that appear throughout the User Manual and that you use good judgment when riding your S1. Remember to pass on this User Manual and the safety video if you ever resell your S1. If you have questions, or need another copy of the User Manual, contact an Authorized Smacircle Dealer or Distributor, or Smacircle LMT before you attempt to use your S1. For a list of Authorized Smacircle Dealers and Distributors, please visit <https://www.smacircle.com>

Check our website regularly for updates to S1 User Materials: <https://www.smacircle.com>

THE RISK OF INJURY

The S1 is an electric personal transporter. Please ride S1 correctly and safely.

WARNING:

Whenever you ride the Smacircle S1, you risk death or serious injury from loss of control, collisions, and falls. To reduce risk of injury, please read and follow all instructions and warnings in the user materials.

BEFORE YOU BEGIN

Before you begin, it may be necessary to unfold your S1. The battery should be charged for 3 hours. To unfold the S1 and charge the battery for the first time, refer to the instructions in this manual.

RELATED USER MATERIALS

Safety Video: A Safety Video is on the APP. It provides important information on how to use your S1. To reduce the risk of injury, please watch and follow all instructions and warnings in the Safety Video before you ride.

If you have any problems reading the User Manual or viewing the Safety Video, contact your Smacircle dealer as soon as possible.

SAFETY MESSAGING

Smacircle takes all aspects of safety very seriously. Our publications and documentation provide clear and consistent safety messaging designed to offer instructions and procedural information that help avoid physical injury or damage to your S1.

Of course, it is impossible to predict and warn against every possible harm or hazard that exists. Thus, users must also use their own intuition and common sense to help avoid physical injury or damage to your S1.

The following safety messaging conventions are used throughout this guide:

WARNING:

Warns you about actions that could result in death or serious injury.

CAUTION:

Warns you about actions that could result in minor or moderate injury.

NOTICE:

Indicates information considered important, but not related to personal injury. Examples include messages regarding possible damage to the S1, other property, or usage tips.

PRODUCT INTRODUCTION

Smacircle S1 Model Description

Model: Smacircle S1 (10001)

Smacircle S1 is the first generation of Smacircle micro-mobility. It is portable and foldable and the smallest and lightest of its kind. It is for indoor/outdoor use in a wide variety of environments.



Smacircle S1 Specifications

The table shows the specifications for the Smacircle S1 model described in this manual.

Performance Indicators	Item	Specification
Material	Body Material	Carbon Fiber
Size	Unfolded Size	950 x 860 x 470 mm (37.40 x 33.85 x 18.50 in)
	Folded Size	290 x 530 x 200 mm (11.41 x 20.86 x 7.87 in)
Main Parameter	Maximum Speed	20 km/h (12.43 mi/h)
	Maximum Incline	12°
	Maximum Load	100 kg (220.46 lbs)
	Mileage Range	17 - 20 km (10.56 - 12.43 mi)
	IP Rating	IPX4
Battery	Type of Battery	Samsung Rechargeable Lithium Battery
	Voltage	36.5 V
	Battery Capacity	5.5 AH
Charger	Rated Input Voltage	100 - 240 V 50/60 Hz
	Charging Time	3.5 hours
USB Charger	USB Output Voltage	5 V
	USB Output Current	1.0 A

Operating Limits

It is important that you familiarize yourself with the operating limits of the Smacircle S1. These limits are set to maximize rider safety while reducing the risk of damage to the Smacircle S1. The Smacircle S1 will perform better when you observe these limits.

The rider's weight must not be exceed 100 kg (220.46 lbs)

Smacircle sets weight limits for two reasons:

- Rider's safety
- To reduce the risk of damage to the S1



WARNING:

Exceeding the weight limit, especially when combined with other variables that require more power, will increase your risk of falling or damaging the Smacircle S1.

Variables that require more power include:

- Higher payloads (weight of rider and all cargo)
- Steeper slopes
- Bumpier surface conditions
- Higher speeds
- Abrupt maneuvers

Maximizing Range

Maximum range distances are provided in the table above. The range of your Smacircle S1 is affected by many variables, including:

- Terrain: Riding on smooth, flat terrain improves range, while riding on hilly terrain and unpaved surfaces reduces range.
- Speed and Riding Style: Riding at a consistent, moderate speed will increase range. Frequent starting, stopping, acceleration, and deceleration, reduces range.
- Rider Weight and Cargo: Lighter riders with less cargo experience better range than heavier riders with more cargo.
- Temperature: Storing, charging, and riding in temperatures close to the median of the recommended temperature range improves range. Riding in colder temperatures reduces range significantly.
- Battery Condition: Properly charged and maintained batteries provide greater range. Old, cold, heavily used, or poorly maintained batteries provide less range.
- Wind: Riding with a tailwind increases range. Riding against a headwind reduces range.

Smacircle S1 Display

The picture below shows a breakdown of every major component of the Smacircle S1.

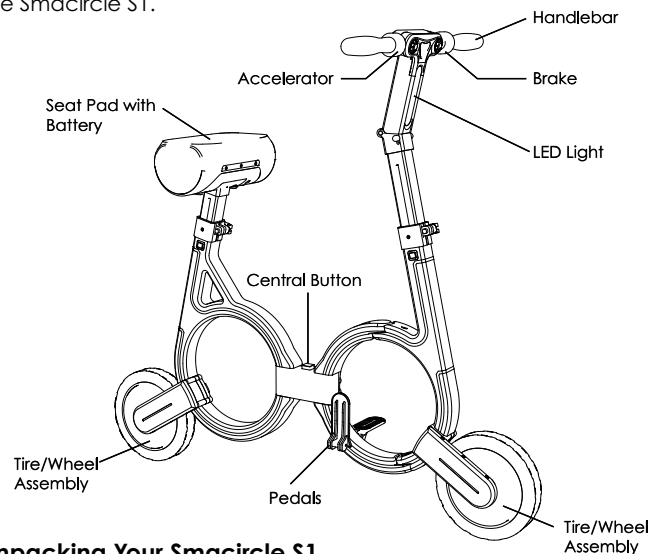

Unpacking Your Smacircle S1

The following items ship with your Smacircle S1:

- Charger
- User Manual
- Quick Start Guide

UNFOLDING YOUR SMACIRCLE S1

WARNING:

Whenever you ride your S1 you risk injury or death from loss of control, collisions, and falls. Be sure to read the User Manual and watch the Instruction Videos before riding.

UNFOLDING STEPS

1

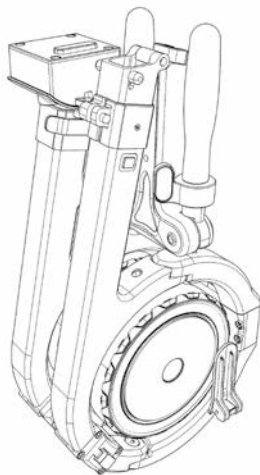

2

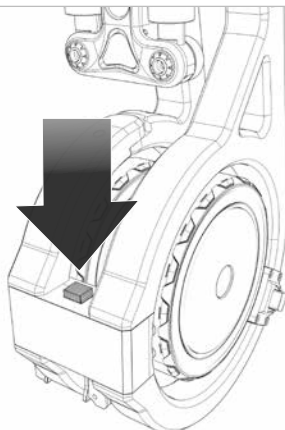

Press the central button to unlock the S1's folding system

3

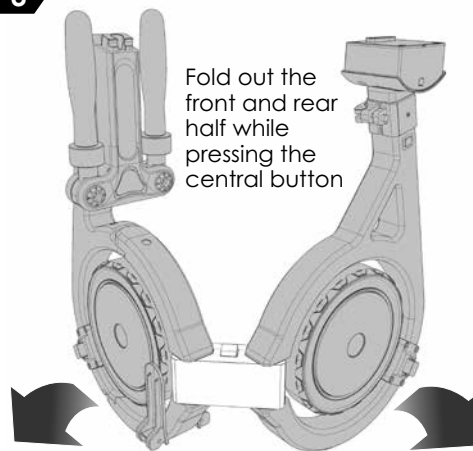

Fold out the front and rear half while pressing the central button

4

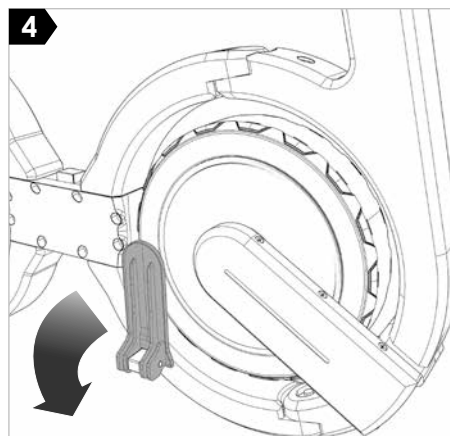

Rotate and flip down both pedals

5

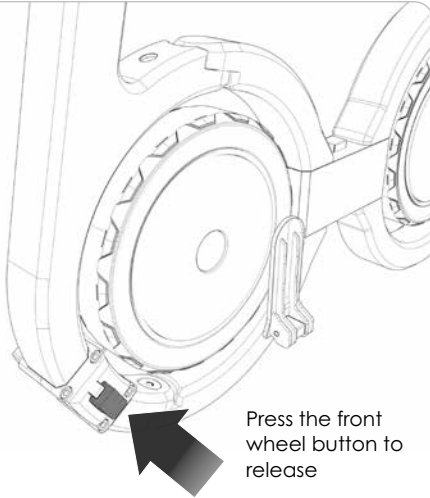

Press the front
wheel button to
release

6

Rotate the front wheel 180°

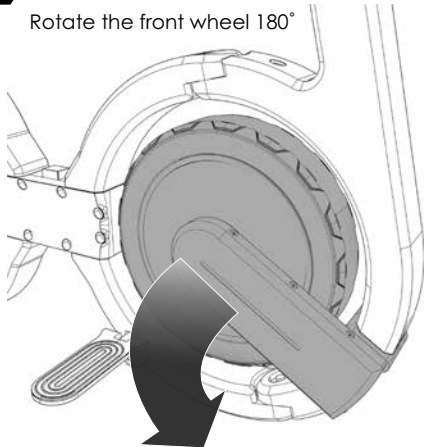

7

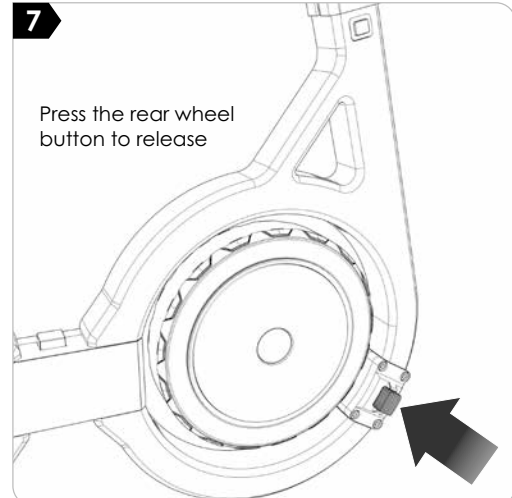

Press the rear wheel
button to release

8

Rotate the rear
wheel 180°

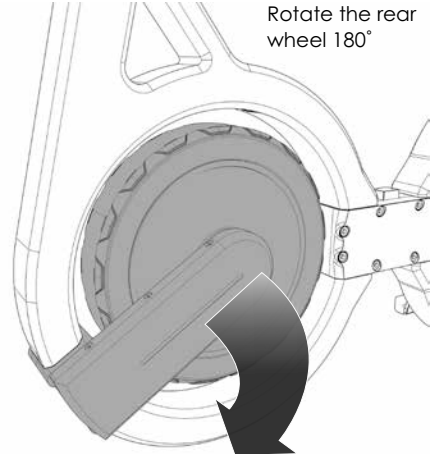

9

Loosen the
front lock
clamp

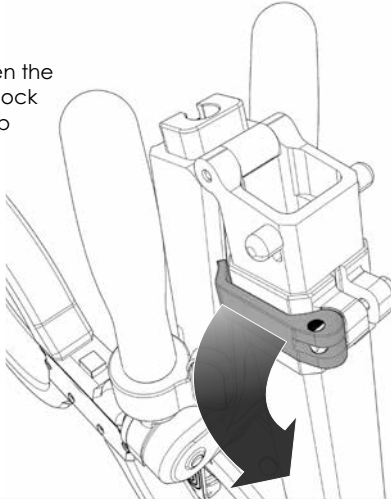

11

Make sure the
front button is
in position

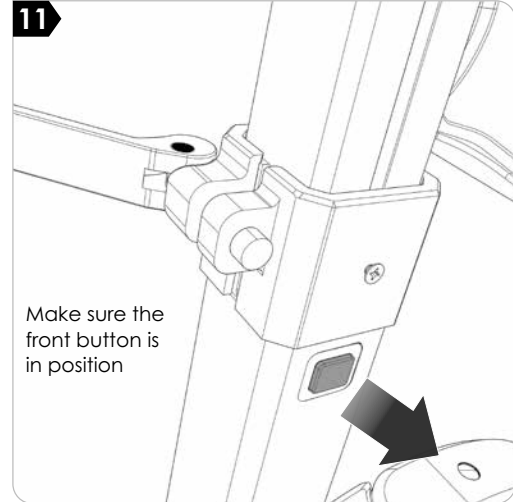

10

Bar
Handlebar

Slide the
neck
upward

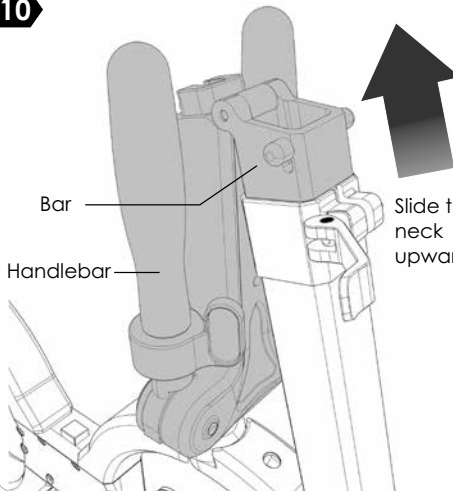

12

Lock the front
lock clamp

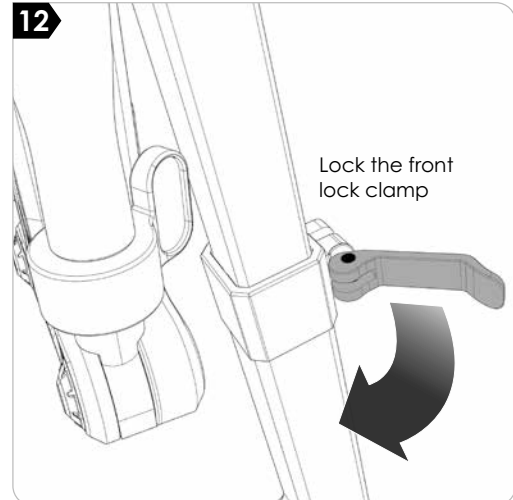

WARNING:

Beware of moving parts that may cause minor injuries to fingers and/or hands.

WARNING:

Beware of moving parts that may cause minor injuries to fingers and/or hands.

13

Unfold the upper portion of the S1 by 180°

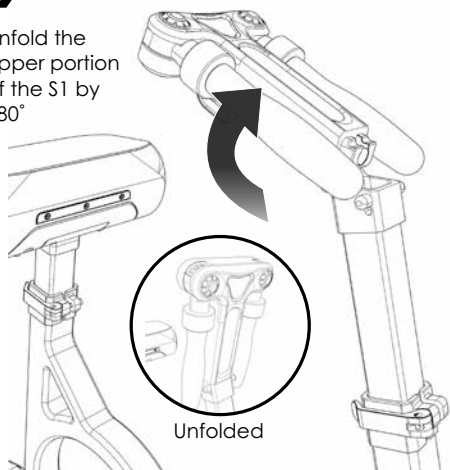

Unfolded

14

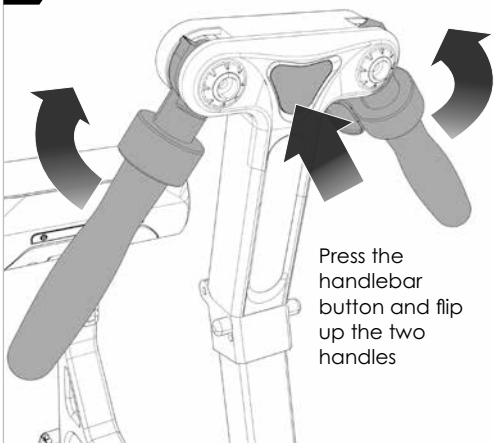

Press the handlebar button and flip up the two handles

15

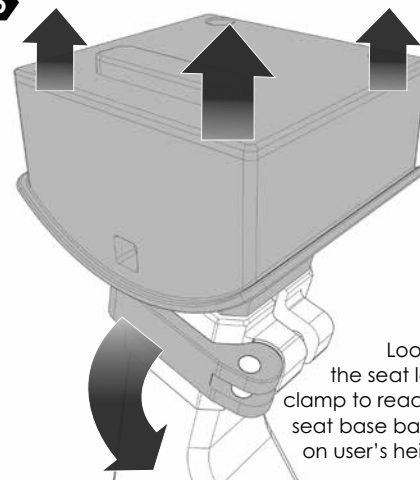

Loosen the seat lock clamp to readjust seat base based on user's height

16

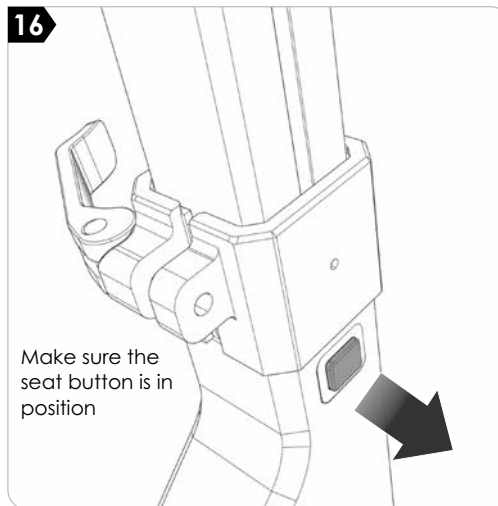

Make sure the seat button is in position



WARNING:

Beware of moving parts that may cause minor injuries to fingers and/or hands.



WARNING:

Beware of moving parts that may cause minor injuries to fingers and/or hands.

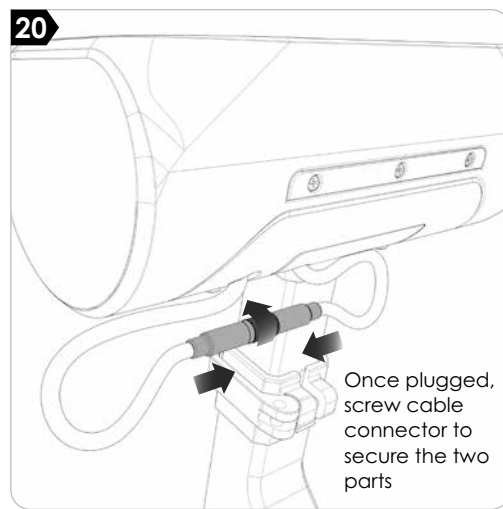
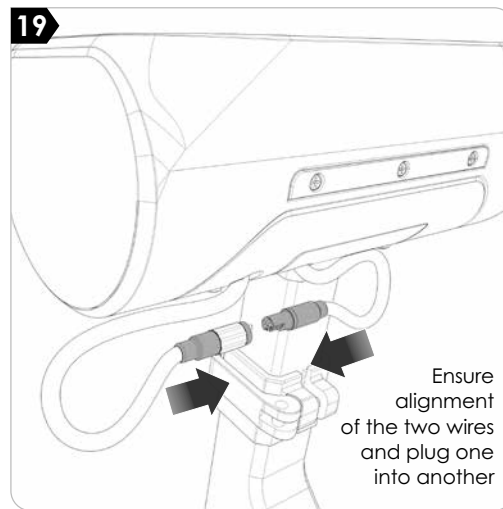
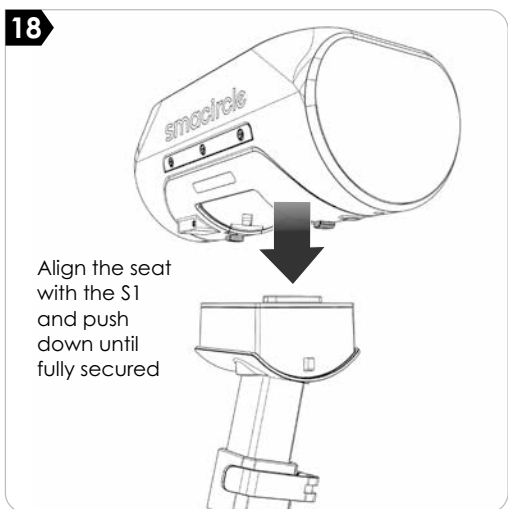
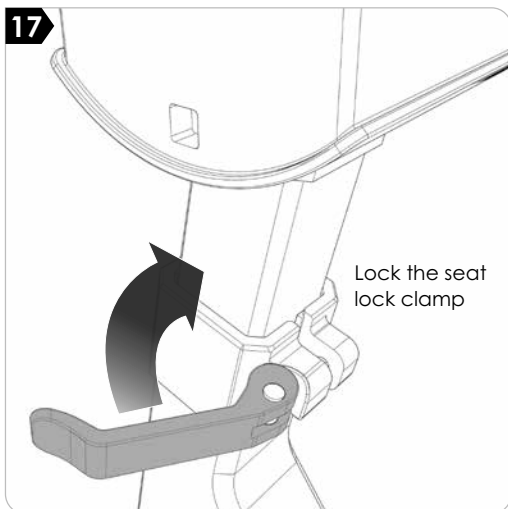

⚠ WARNING:

Beware of moving parts that may cause minor injuries to fingers and/or hands.

⚠ WARNING:

Beware of moving parts that may cause minor injuries to fingers and/or hands.

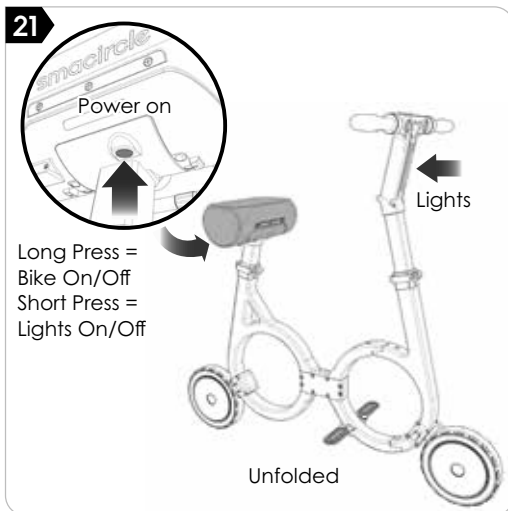

⚠ WARNING:

Beware of moving parts that may cause minor injuries to fingers and/or hands.

FOLDING YOUR SMACIRCLE S1

⚠ WARNING: Please make sure the S1 is off before folding it.

⚠ WARNING: Temperature of motor (rear wheel) will be high after a long ride, please be careful of burns when folding.

FOLDING STEPS

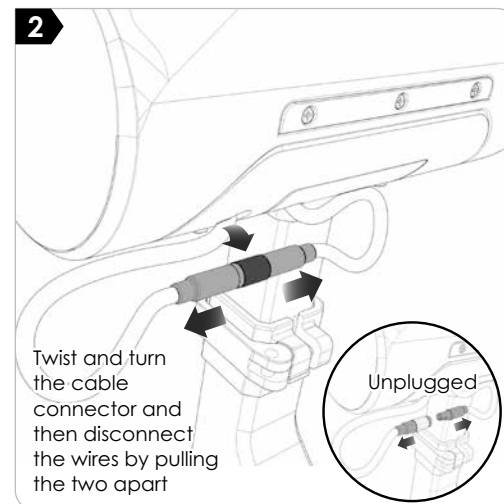
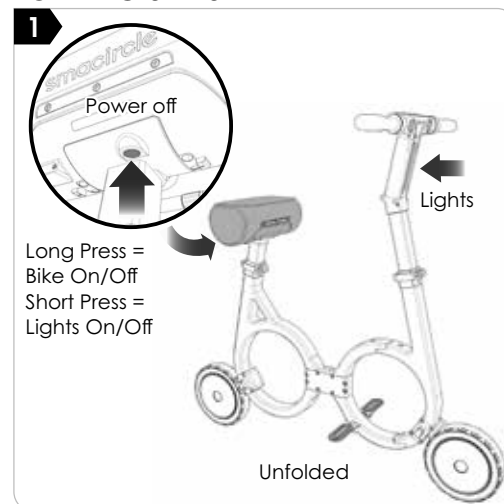

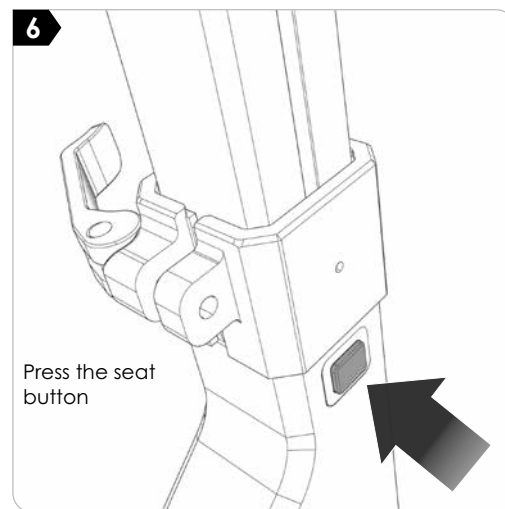
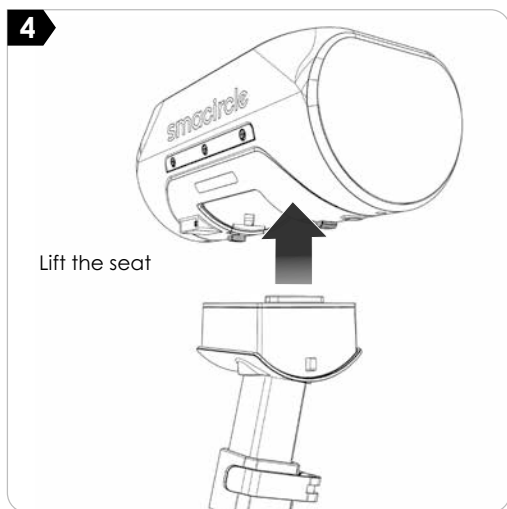
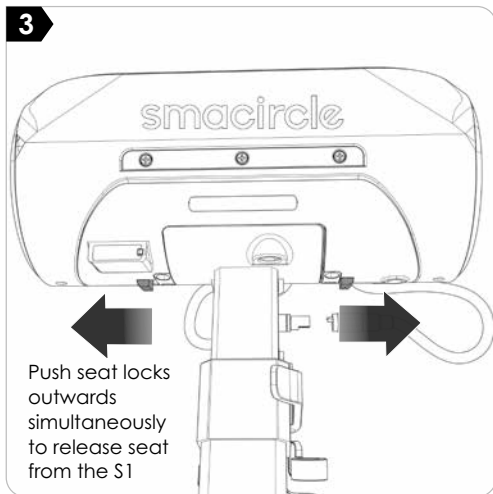

⚠ WARNING:

Beware of moving parts that may cause minor injuries to fingers and/or hands.

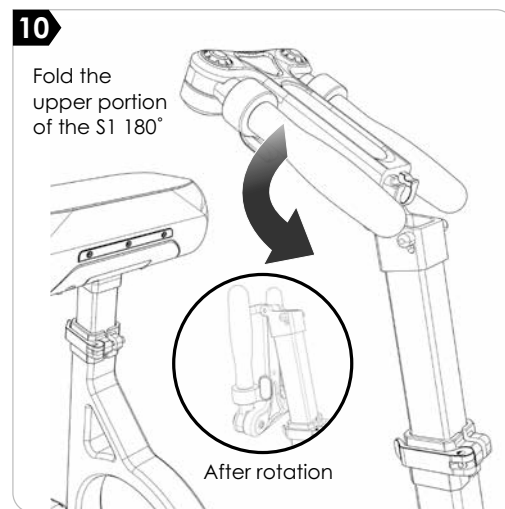
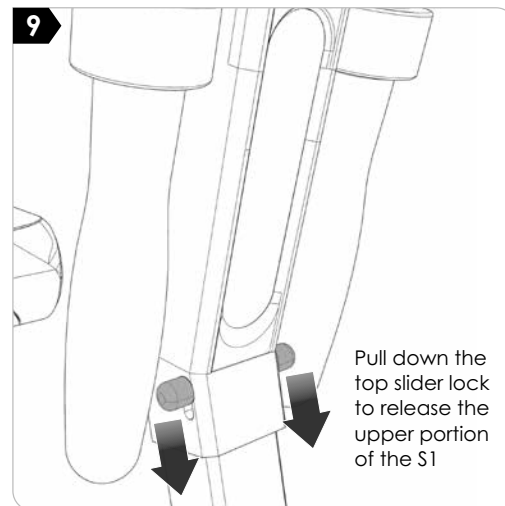
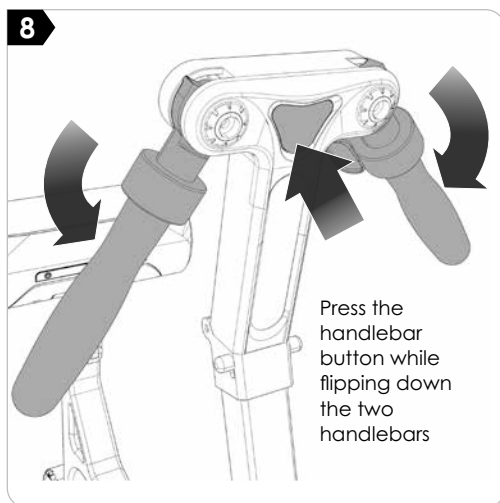
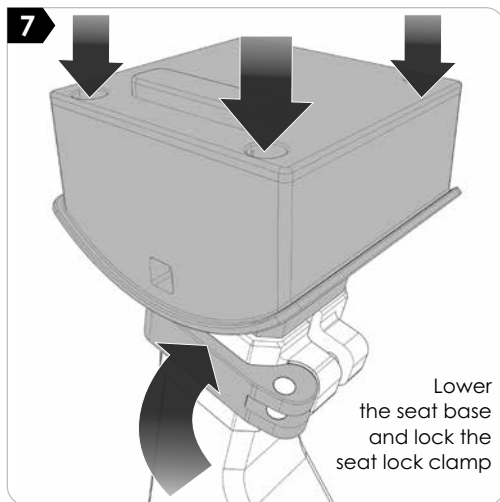

WARNING:

Beware of moving parts that may cause minor injuries to fingers and/or hands.

WARNING:

Beware of moving parts that may cause minor injuries to fingers and/or hands.

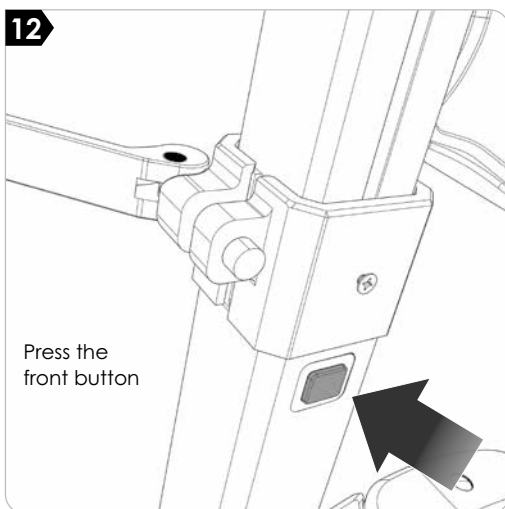
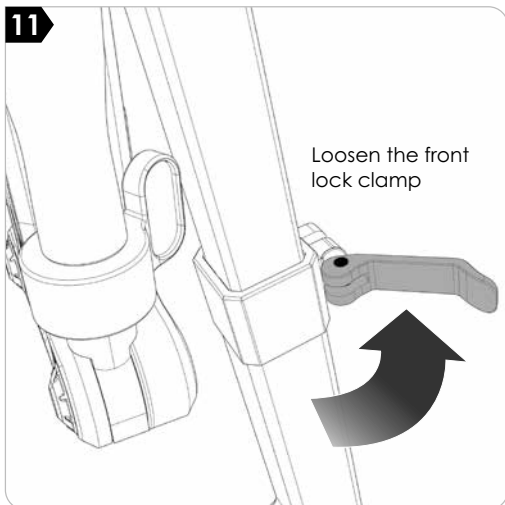

⚠ WARNING:

Beware of moving parts that may cause minor injuries to fingers and/or hands.

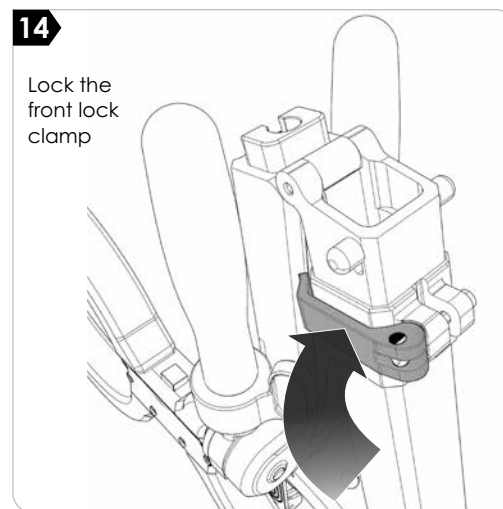
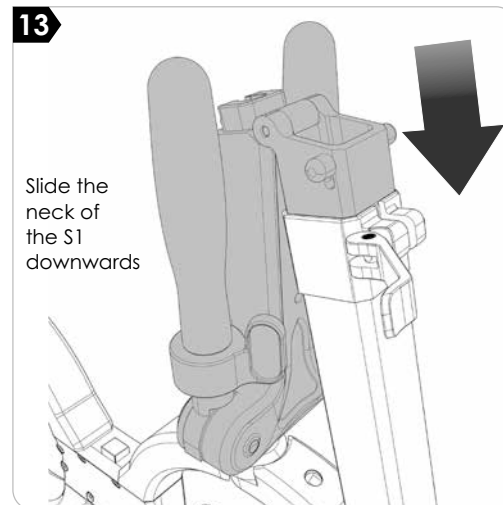

⚠ WARNING:

Beware of moving parts that may cause minor injuries to fingers and/or hands.

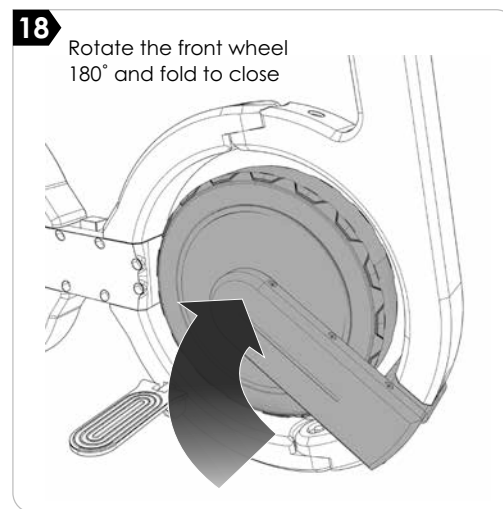
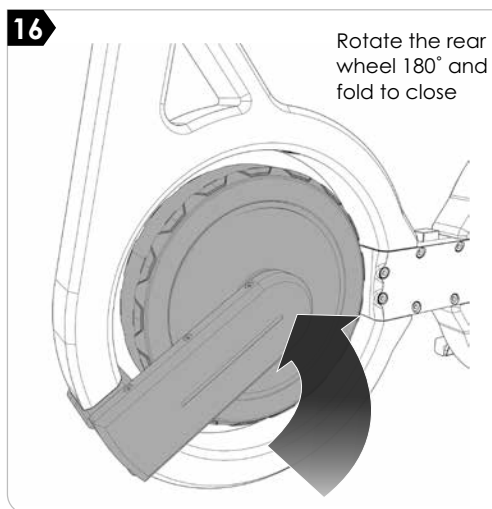
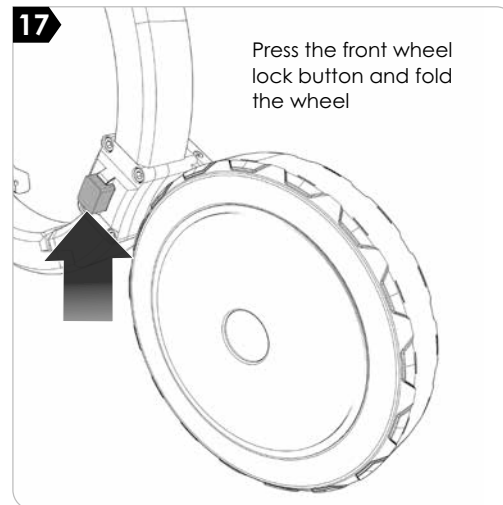
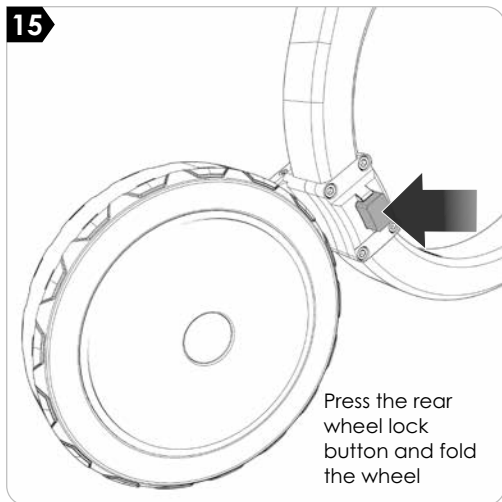

⚠ WARNING:

Beware of moving parts that may cause minor injuries to fingers and/or hands.

⚠ WARNING:

Beware of moving parts that may cause minor injuries to fingers and/or hands.

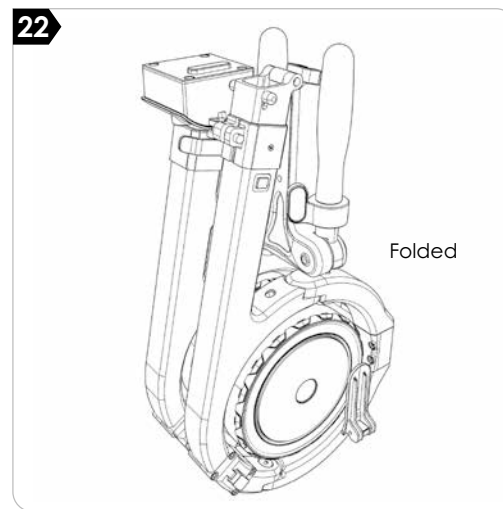
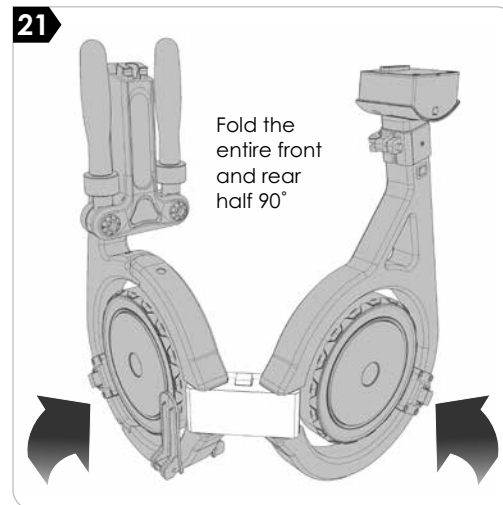
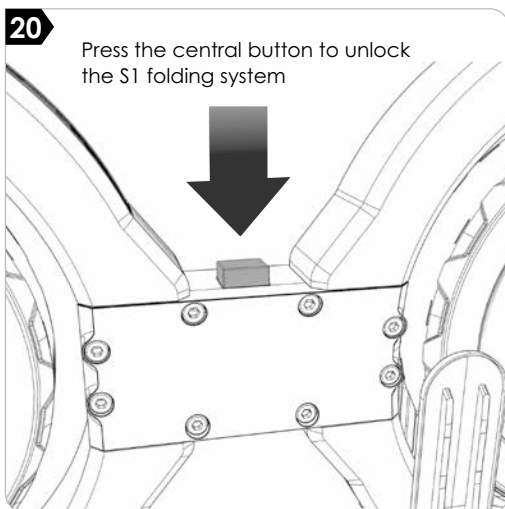
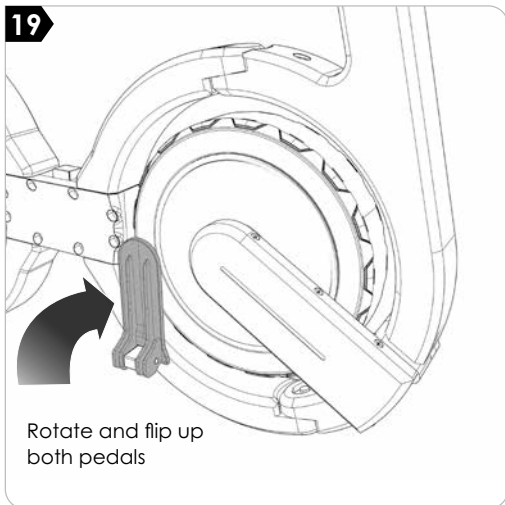

⚠ WARNING:

Beware of moving parts that may cause minor injuries to fingers and/or hands.

RIDING YOUR SMACIRCLE S1

This section describes how to ride the Smacircle S1. It discusses riding for the first time and gives guidelines and helpful hints for all rides. Follow these steps to learn how to ride your S1. It is important that you practice riding in a controlled, familiar environment until you are comfortable using your S1.

Before riding, make sure your S1 is unfolded and charged. See “Unfolding your Smacircle S1” chapter, and “Charging Your Batteries” chapter. Inspect your S1 before each use. Do not ride if any part is loose or damaged. Do not wear loose clothing or jewelry that could get caught in the S1.

Your posture and stance affect your ability to ride safely:

- Be alert! Scan both far ahead and close to the wheels: your eyes are your best tool for safely avoiding obstacles and slippery surfaces.
- Keep a firm grip on the handlebar, your legs relaxed, and knees and elbows bent. This helps you maintain your balance over rough terrain.
- Leave a gap between yourself and the handlebar. Do not lean over or into the handlebar. Leaning over or into the handlebar dramatically increases the risk of collisions, falls, and loss of control.
- Keep your feet centered on the pedals.
- Practice turning.
- Practice controlled stopping.
- Make sure the handlebar is set to the correct height.

Avoiding Hazards

You must always be careful when riding and learn to identify, prevent and avoid slippery, icy, or wet surfaces, loose materials (sand/gravel), steep slopes, and obstacles.

Avoiding Slips

Slips occur when the tires lose traction, potentially causing loss of control and a falls. Abrupt maneuvers, riding over slippery surfaces, loose objects and materials, or steep slopes can cause the tires to lose traction.

- Avoid abrupt maneuvers such as sudden stopping or starting, especially on wet and/or uneven surfaces.
- Avoid riding on slippery surfaces such as snow, ice, wet floors, wet grass, or any other surface that might cause slipping.
- Avoid riding over loose objects or materials such as small branches, litter, small stones, manhole covers or road repair plates.
- Use caution when riding over any terrain change such as pavement to grass, or over a threshold or speed bump.
- Avoid riding on steep slopes. Maintain tire contact with the ground.
- Avoid turning on slopes or ramps.
- Never let go of the handlebar when riding across a slope. The S1 will turn downhill causing loss of balance and/or control.

Step 1: Preparing for Your Ride

To prepare for your first ride:

1. Select an appropriate area for your first ride. This area may be indoors or outdoors. It should have a flat, smooth riding surface with good traction and should be free of obstructions and away from vehicles, bicycles, pets, small children, and any distraction.
2. We recommend that you use a spotter who has studied all the instructions and warnings in this manual and the Safety Video to help you and assist you with the instructions.
3. Put on your helmet and fasten and adjust the chin strap in accordance with the helmet manufacturer's instructions.
4. Move the S1 to the center of the riding area.
5. Unfold the S1 in accordance with the instructions.
6. Adjust the seat and the handlebar to the suitable height according to your height.
7. Familiarize yourself with the icons that may be displayed on the Smacircle App.

Step 2: Powering On the Smacircle S1

Turn on your S1 by pressing the Power button under the seat for one second. You will hear a short sound from the S1 to indicate the power is ON.

Step 3: Riding

Before you attempt to ride for the first time:

- Have your spotter stand beside the S1, face you, and hold either you or the seat securely. Your spotter should be prepared to help you maintain your balance.
- Remember, the S1 will move forward if you press the accelerator. Be careful not to accidentally press it when you first mount your S1.
- Always keep in mind that electric engines have instant torque. Therefore, the moment you push on the accelerator controller, the bike will immediately accelerate forward with great thrust. Do not fully press the accelerator controller, until you are familiar with the technology and behavior of the S1.

To ride the S1:

1. Take a seat on the S1.
2. Hold the handlebar firmly with both hands.
3. Glide your feet on the ground as you slowly press the accelerator button.
4. Place foot on the pedal after gaining some speed and stability. Stay calm and relaxed. Look forward. Press the accelerator to control the speed (0-20 km/h). The more you press, the faster the S1 will run.

NOTE: For safety concern, Smacircle S1 is defaulted to be non-zero start-up. This means that the throttle can work only after the motor (rear wheel) is worked by external force.

NOTE: For safety concerns, Smacircle S1 turns off automatically if kept idle for more than 5 minutes.

NOTE: Some people may feel unstable when they ride for the first few meters.

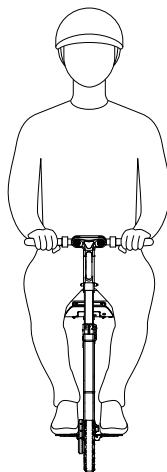

Step 4: Stopping

Stop the Smacircle S1 by pressing the brake button on the left handle bar. The harder you press, the greater the braking force will be.

Step 5: Powering Off the Smacircle S1

Turn off the Smacircle S1 by pressing the Power button under the seat for three seconds.

Practice Riding

You will need to become very familiar with your Smacircle S1 before you attempt to ride outside of your controlled practice environment. The more you practice, the safer you will be when you move into new riding areas.

NOTICE: In an emergency, it's recommended to take your feet off the pedals and stop the S1 by using your feet on the ground to slow down.

Turn the Front Lights On/Off

Press the power button for one second when S1 is on: the front light will turn on. Press the power button again for one second to turn off the front light. The rear LED light turns on automatically when you press the brake button when stopping the S1 during the ride.

Smacircle "Power Bank"

There is an USB port on the left side under the seat, users may charge their phone or other electronic equipment devices.

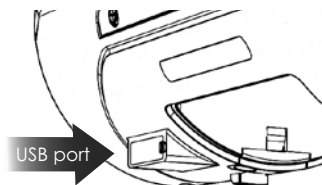

Cruise Control

This option allows the user to set and maintain a constant speed without pressing the acceleration controller. Press the accelerator controller and keep the same speed for 8 seconds and the cruise control will automatically engage. The Smacircle S1 will continue cruising at the same speed without the need to press the accelerator. You can switch the function off by pressing the brake (left) or accelerator (right) once.

Mode Changing

There are two speed modes for S1.

1. Normal Mode: the maximum speed is 15 km/h.
2. Sport Mode: the maximum speed is 20 km/h.
3. Press the power button twice consecutively to change the speed mode and to set the maximum speed. An alternative way is to switch the mode by using the APP.

NOTE: The Smacircle S1 default mode is Normal.

Self-Protection Function

If the motor temperature exceeds 120°C or the controller temperature exceeds 90°C, the controller will alarm and stop working. (see "Troubleshooting the S1", P.41)

Riding Etiquette

Use proper etiquette when riding your S1.

- Be careful and considerate of others.
- Always ride under control at a speed that is safe for you and those around you.
- Always be prepared to stop.
- Respect pedestrians by always yielding to their right of way.
- Avoid startling pedestrians. When approaching from behind, announce yourself by voice or with the accessory bell, and slow down to walking speed when passing. When approaching a pedestrian from the front, slow down and adjust your path of travel to avoid any collision and help the pedestrian predict your direction.
- In heavy pedestrian traffic, slow down and proceed at the pace of pedestrian traffic. Pass only if there is enough space to do so safely. Do not weave in and out of pedestrian traffic.
- When riding with other S1 riders, maintain a safe distance from each other, identify hazards and obstacles, and do not ride side-by-side unless there is plenty of room left for pedestrians.
- Do not park your S1 in a way that blocks pedestrian traffic.
- Cross roads at designated crosswalks or signaled intersections. Do not jaywalk/ride.
- Only travel on a road when a pedestrian way is not available or when sidewalk use is not allowed. Do not ride your S1 on private property (inside or outside) unless you have obtained permission to do so.
- Learn about and obey applicable local laws and regulations.

Riding Tips and Safety Guidelines Recap

When riding the Smacircle S1, please pay attention to the riding tips and safety guidelines below.

- Read this Manual and watch the Safety Video.
- Pre-ride inspection: Inspect your S1 before each use. Do not use if any part is loose or damaged. If you discover any loose or damaged part, please contact your local distributor or contact Smacircle.
- Do not allow any person to use your S1 unless that person has carefully read this Manual and watched the Safety Video.
- Do not use the S1 in hazardous atmospheres. Hazardous atmospheres are locations where fire or explosion hazards may exist due to flammable gases, vapors, liquids, dust, or fibers.
- **Wear a helmet!** Whenever you ride your S1 wear a helmet that fits properly with the chin strap in place. Use an approved bicycle or skateboard helmet that provides protection for the back of your head. Depending on riding conditions and your riding experience, consider using additional protective equipment such as gloves, eye protection, wrist guards, knee pads and back protectors. Wear footwear that protects your feet and provides adequate support and comfort.
- Avoid slippery surfaces, loose materials, steep slopes, and obstacles. If you cannot avoid these conditions, then stop riding and walk. Be especially careful when riding in confined spaces or near obstructions.
- **Use caution on slopes.** Use caution when ascending, descending, or crossing slopes. Do not attempt to ride across any slopes with loose material or slippery surfaces. Instead, stop riding and walk with the S1 downhill from you. When riding across any slope, lean uphill to maintain balance and be prepared to press the brake.
- **Be careful when turning!** Always reduce speed before turning and then turn slowly with caution. Turning at high speeds can lead to loss of control and falls. Lean into turns to improve balance and stability.
- **Do not take risks!** When you encounter a slope, uneven terrain, or other terrain feature with which you are not experienced or that makes you at all concerned about your safety, do not risk riding. Instead, stop riding and walk.
- **No passengers.** The S1 is for one rider. Do not ride double or carry any passengers. Do not carry a child in your arms or in a child carrier while riding. Expectant mothers should not ride the S1.
- Do not exceed the maximum weight limit (rider and all cargo) specified in this Manual.
- Never ride on stairs, escalators, or through revolving doors as this is extremely dangerous.
- Do not get off a moving S1. Always come to a complete stop before dismounting.

- **Be alert!** As with any other transportation device, you must be mentally alert to safely ride a S1. Do not attempt to ride if you are ill or if you cannot comply fully with the instructions and warnings in this Manual. Do not ride under the influence of alcohol or drugs. Avoid distractions. Do not use a mobile phone, wear headphones, or engage in any other activity that might distract you or interfere with your ability to monitor your surroundings while riding.
- Be prepared to stop. Be especially careful when approaching or crossing intersections, driveways, corners, doorways, crowded spots and other areas where you may need to slow down or stop to avoid motor vehicles, bicyclists, or pedestrians.
- Never restart and ride your S1 after the battery indicator is low. The S1 may not have enough power to function, especially if you demand a lot of power at once. If you restart and continue riding, you may damage your battery, resulting in reduced battery life and capacity.
- **Leave a gap!** Leave a gap between yourself and the handlebar. Do not lean over or into the handlebar as this dramatically increases the risk of loss of control, collisions, and falls.

Report All Incidents

If you or any other user of your S1 is involved in an accident, or if your S1 performs in a way that you do not intend or in a way that it is not supposed to, contact Smacircle Technical Support.

For detailed contact information, please visit at Smacircle Website: www.smacircle.com

APP

What You Can Do with the Smacircle APP

1. Turn on/off the front light by clicking the Smacircle logo at the bottom of the home interface.
2. Click the *SPORT* area to adjust speed mode of S1 to set the maximum speed. Normal mode: The maximum speed of S1 is 15 km/h, Sport mode: The maximum speed of S1 is 20 km/h.
3. Monitor the battery life, riding mileage and single trip distance.
4. Lock/unlock the S1 by clicking the lock icon on the the top-left corner. (If you lock the S1 through the APP, nobody can ride the S1 until you unlock it through the APP.)



How to Download and Open the Smacircle APP

Please scan the QR code below to download the Smacircle APP. Alternatively, please go to the Google Play Store (Android) or the Apple App Store (iOS) and search for "Smacircle" to download and install the App.



Tip: Please go to Account> Settings> My Device> Operation Guide for instructional videos.

Sign up and Login in

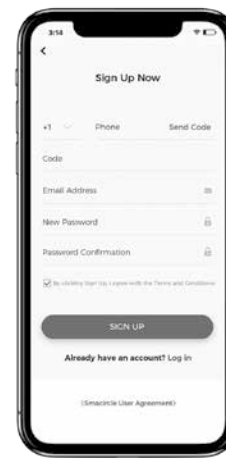

1. After entering the login interface, tap Sign Up.

2. Tap Send Code to receive verification from our system; enter the code and tap Sign Up.



3. Login with your phone number and password.

Tip: A Bluetooth tutorial will pop up after you login teaching you how to sync your phone with the Smacircle S1.

Activate Your Smacircle S1

Tips: The S1 is locked by default; it needs to be activated and unlocked in the Smacircle APP.

The warranty period starts upon activation.

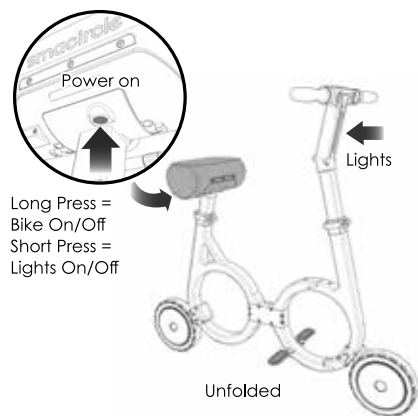

1. Turn on the S1 before activation.



2. Tap the Bluetooth icon on the upper right hand corner of the home interface.



4. You can check the activation status of your S1 and view your S1 warranty information on My Device> Device Activation interface.

(If it shows your S1 is not activated, please go to Smacircle official website www.smacircle.com and enter your information into Warranty form or contact us.)

Set S1 Bluetooth Password

You can set the Bluetooth password of your S1 so that others cannot connect their phone to your S1 without the password.

Enter My Account interface and tap Settings> Update Bluetooth Password and enter the required information.



3. Select Smacircle-[####] amongst the available devices on your screen. Once selected, your S1 is activated.



SMACIRCLE S1 BATTERY & CHARGER

Battery Safety

WARNING:

- Turn S1 off before charging.
- Do not use the Battery if it emits an unusual odor, smoke, excessive heat or leaks any substance. Avoid contact with any substance seeping from the battery.
- Keep out of reach of children and pets. Exposure to battery voltage could result in death or serious injury.
- Unplug or disconnect the S1 from AC power before removing or attaching the battery or performing any service. Never work on any part of the S1 when it is plugged into AC power. You risk serious body injury from electric shock as well as damage to the S1.
- Each Smacircle S1 is equipped with a special battery and a special smart charger. These accessories that come with each Smacircle S1 have a dedicated number. Please do not use the chargers from other brands. Smacircle will be not responsible for any damage that occurs from charging the battery with other chargers.
- The cells within the battery contain toxic substances. Do not attempt to open the battery. Do not insert any object into the battery or use any device to try to open the battery casing. If you insert an object into any of the battery ports or openings you could suffer electric shock, injury, burns, or cause a fire. Attempting to open the battery casing will damage the casing and could release toxic and harmful substances and will render the pack unusable.
- Failure to properly charge the battery could result in permanent damage. Left unplugged, the battery could fully discharge over time causing permanent damage.
- Use only charging devices approved by Smacircle and never attempt to bypass or override their charging protection circuits.
- Do not wash the Smacircle S1 with a power washer or high pressure hose. Avoid getting water into the Charging Port. Always close the Charging Port Cover after charging. Avoid exposure to heavy downpours or extended periods of heavy rain (including during riding, storage, or while being transported). Clean with soap and water and a soft cloth. Make sure that the Charging Port is dry before plugging in the Power Cord. Failure to follow these instructions could expose you to electric shock, injury, burns, or cause a fire.
- Do not submerge the battery or the electric engine inside the rear wheel in water. If you suspect the battery or the rear wheel has been submerged or experienced water intrusion, call Smacircle Technical Support immediately. Until you receive further instructions, store the battery outdoors, and away from flammable objects. Do not attempt to remove the battery if it is already on S1. Do not plug the Power Cord into the S1. Failure to follow these instructions could expose you to electric shock, injury, burns, or cause a fire.

- Do not charge the battery if the charger is too hot.
- As with all rechargeable batteries, do not charge near flammable materials.

Charging Your Battery

In order to maintain the best performance from your S1 battery, fully charge the battery for at least 3.5 hours once every 2 months. Charge your battery only when it is within the specified charging temperature range. Charger port is located on the right side under the seat.

Operation temperature range: 0-45 °C for Charge and Discharge.

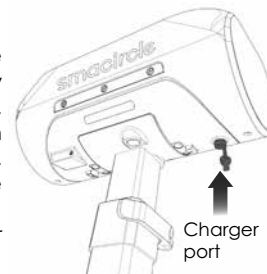

WARNING:

- During the charging, do not stack flammable and explosive materials around the battery. When the charging indicator turns green, please unplug the charger as soon as possible and do not charge it for a long time.
- Never use a third-party charger or a third-party regulated power supply to charge Smacircle battery.

Charger Indicator Lights

S1 is charging when the light on the charger is red. The light will change to green when the battery is fully charged.

Charger

Smacircle provides a dedicated charger which has a charging protection function. Fully charging time is around 3.5 hours. Water immersion, collisions, and other abnormal factors can lead to charger damage which is not covered under warranty.

Battery

Model: ICR18650-2750mAh-29E 10S2P FY1505462000

Made by Shenzhen Poweroak Newener Co.,Ltd.

Input: 100-240 VA.C., 50/60 Hz, 2.0 A.

Output: 42.0 VD.C., 2.0 A

UL listed (E483915)

Battery Transportation, Shipping, and Disposal

If you are transporting your Smacircle S1, protect the battery to avoid damage. Do not expose the battery to direct heat or moisture, and avoid heavy vibration during transportation.

WARNING:

Do not use or transport a battery if the casing breaks open, leaks any substance, becomes excessively hot, or if you detect an unusual odor. Do not handle a damaged or leaking battery unless you are wearing disposable rubber gloves, eye protection, and are in a well-ventilated area. Dispose of the rubber gloves and damaged battery properly in accordance with regulations governing disposal of toxic materials.

Shipping Li-ion Battery

Li-ion batteries are regulated as "Hazardous Materials" internationally. If you need to arrange air shipment of your Li-ion battery, contact an authorized Smacircle Dealer or Distributor for assistance.

You must comply with all local laws when transporting Smacircle S1 Li-ion batteries.

Battery Disposal

The Li-ion battery used in the Smacircle S1 can be recycled. Recycle or dispose of battery in accordance with local environmental regulations. Do not place in fire or incinerate.

MAINTAINING YOUR SMACIRCLE S1

The Smacircle S1 is designed to be virtually maintenance free. Make sure it is clean, all parts are installed and functioning properly and that the battery is charged prior to riding.

Maintaining Tires and Wheels

To ensure safe and efficient operation of your S1, be sure to check tires and wheels regularly; especially if you have recently performed service on the Tire/Wheel Assembly.

Checking the Tire/Wheel Assembly

To check the tires and wheels:

1. Make sure the S1 is unplugged and powered off.
2. Check for wheel wobble by grasping the Tire/Wheel Assembly and attempt to move it side-to-side. The Tire/Wheel Assembly should not move laterally. If you detect wheel wobble, check the wheel nut and tighten if necessary.

Cleaning Your Smacircle S1



WARNING:

Do not clean the seat or tires with any specialized cleaners. Do not use solvents or harsh abrasives to clean your S1; they may damage the finish or compromise its structural integrity.

To clean your S1:

1. Make sure the S1 is unplugged and powered off.
2. Always close the Charge Port Cover after charging and prior to cleaning.
3. Gently clean your S1 with soap and water and a soft cloth.

Avoid Submerging Your Smacircle S1



WARNING:

Do not wash the S1 with a power washer or high pressure hose. Avoid getting water into the Charge Port. Always close the Charge Port Cover after charging. Avoid exposure to heavy downpours or extended periods of heavy rain (including during riding, storage, or when transporting). Clean with soap and water and a soft cloth. Make sure that the Charge Port is dry before you plug in the Power Cord. Failure to follow these instructions could expose you to electric shock, injury, burns, or cause a fire.



WARNING:

Do not submerge the battery or rear wheel in water. If you suspect the battery or rear wheel has been submerged or experienced water intrusion, call Smacircle Technical Support immediately. Until you receive further instructions, store the S1 outdoors, and away from flammable objects. Do not attempt to remove the battery. Do not plug the Power Cord into the S1. Failure to follow these instructions could expose you to electric shock, injury, burns, or cause a fire.

STORING YOUR SMACIRCLE S1

To store your S1 for the winter or long periods of time, do the following to ensure it will always be ready to supply you with maximum performance:

Smacircle S1

- Store your S1 (and its battery) indoors, in a place that is free of moisture and humidity, with an ambient temperature of -4°F – 104°F (-20°C – 40°C).
- Clean your S1.
- Remove battery.
- You may want to cover your S1 to prevent dust accumulation.
- Prolonged exposure to UV rays, rain and the elements may damage the enclosure materials, store S1 indoors when not in use.

S1 Battery

- Fully charge your battery for 3.5 hours once every 2 months. Charge your battery only when it is within the specified charging temperature range.
- Even if you will not be using your S1 for an extended period of time, you should leave it plugged into AC power, otherwise the battery could fully discharge over time, causing permanent damage.
- If storing your S1 longer than 1 month, remove the battery – but be sure to charge it at least every 2 months.
- If storage temperature is below 32° F/0° C, do not charge your battery. Instead, bring it into a warm environment for charging (above 50° F/10° C). Doing so will ensure optimal battery life and performance.



CAUTION:

Failure to charge the battery could result in permanent damage. Left unplugged, the battery could fully discharge over time, causing permanent damage. Use only charging devices approved by Smacircle.



WARNING:

Risk of Fire-No User Serviceable Parts.



AVERTISSEMENT:

Risque d'incendie - Aucune des pièces ne peut être réparée par l'utilisateur

Troubleshooting the S1

You can troubleshoot certain problems with your S1 before contacting an Authorized Smacircle Dealer or Distributor, or Smacircle Customer Care. This chapter provides lists of problems and recommended actions. If the problem persists even after reviewing the troubleshooting procedures, please contact an Authorized Smacircle Dealer or Distributor, or Smacircle Customer Care. For a list of Authorized Dealers and Distributors, please visit www.smacircle.com

Problem 01: S1 continuously beeps once and headlight flashes once.
Recommended Action: Charge the S1 battery fully.

Problem 02: S1 continuously beeps twice and headlight flashes twice.
Recommended Action: Remove the seat(battery) and then re-install the battery after 10 minutes.

Problem 03: S1 continuously beeps nine times and headlight flashes nine times.
Recommended Action: Turn S1 off and then turn it on 10 minutes later when motor is cool.

Problem 04: S1 continuously beeps ten times and headlight flashes ten times.
Recommended Action: Turn S1 off and then turn it on 10 minutes later when controller is cool.

CONTACT AND LEGAL INFORMATION

Report All Incidents

Please contact Smacircle Customer Care if you or any other user of your Smacircle S1 is involved in an accident or if the S1 performs in an unusual way.

How to Reach Us

An Authorized Smacircle Dealer or Distributor can answer questions about your Smacircle S1 via the web, email, or phone. For a list of Dealers and Distributors, please visit www.smacircle.com or you could contact us by 86 755 8294 8324.

Laws and Regulations

Many governmental authorities regulate use of Smacircle S1 on public roads and sidewalks. In addition to other requirements, these laws and regulations may prescribe minimum ages for Smacircle S1 users and may set speed limits and mandate protective gear for riders and compulsory insurance. Some governmental authorities prohibit use of S1 on public roads and sidewalks and some governmental authorities may limit use of S1 only on private space. You should consult local authorities to become familiar with applicable laws and regulations and always obey those applicable laws and regulations when using S1. To the fullest extent permissible by the applicable law, we hereby disclaim all liability for any and all responsibility, risk, liability, and damages including death or personal injury resulting from use of the S1 while disregarding local traffic laws and regulations.

California Energy Commission (CEC) Battery Charger (BC) Mark



The Smacircle S1 has been certified to comply with the 2019 APPLIANCE EFFICIENCY REGULATIONS and California Code of Regulations, and as such can bear the California Energy Commission (CEC) BC mark.

FCC STATEMENT

This device complies with part 15 of the FCC Rules. Operation is subject to the following two conditions: (1) This device may not cause harmful interference, and (2) this device must accept any interference received, including interference that may cause undesired operation.

This device must not be co-located or operating in conjunction with any other antenna or transmitter.

This equipment has been tested and found to comply with the limits for a Class B digital device, pursuant to part 15 of the FCC Rules. These limits are designed to provide reasonable protection against harmful interference in a residential installation. This equipment generates, uses and can radiate radio frequency energy and, if not installed and used in accordance with the instructions, may cause harmful interference to radio communications. However, there is no guarantee that interference will not occur in a particular installation. If this equipment does cause harmful interference to radio or television reception, which can be determined by turning the equipment off and on, the user is encouraged to try to correct the interference by one or more of the following measures:

- Reorient or relocate the receiving antenna.
- Increase the separation between the equipment and receiver.
- Connect the equipment into an outlet on a circuit different from that to which the receiver is connected.
- Consult the dealer or an experienced radio/TV technician for help.

Portable devices:

This device complies with FCC's radiation exposure limits set forth for an uncontrolled environment.

WARNING: Any changes or modifications to this unit not expressly approved by the party responsible for compliance could void the user's authority to operate the equipment.

This device must not be collocated or operating in conjunction with any other antenna or transmitter.

Attention: Certification and Engineering Bureau

This letter is to confirm that we have accepted the responsibility to act as Canadian Representative on behalf of the Applicant noted below all future industry Canada certification / registrations obtained during the period of this agreement which end at the specific date below (if applicable).

As Canadian Representative, we are aware of the requirement involved as outlined in Industry Canada applicable documents (RSP-100 issue 11, section 2.1 and/or DC-01 issue 7, section 3)

Attention: Certification and Engineering Bureau

This letter is to confirm that we have accepted the responsibility to act as Canadian Representative on behalf of the Applicant noted below.

As Canadian Representative, we are aware of the requirement involved as outlined in Industry Canada applicable documents (RSP-100 issue 11, section 2.1 and/or DC-01 issue 7, section 3)

IC Statement

This device complies with Industry Canada license-exempt RSS standard(s). Operation is subject to the following two conditions: (1) this device may not cause interference, and (2) this device must accept any interference, including interference that may cause undesired operation of the device.

Le présent appareil est conforme aux CNR d'Industrie Canada applicables aux appareils radio exempts de licence. L'exploitation est autorisée aux deux conditions suivantes: (1) l'appareil ne doit pas produire de brouillage, et (2) l'utilisateur de l'appareil doit accepter tout brouillage radioélectrique subi, même si le brouillage est susceptible d'en compromettre le fonctionnement. The device is compliance with RF field strength limits, users can obtain Canadian information on RF exposure and compliance.

Le présent appareil est conforme de ce matériel aux conformités ou aux limites d'intensité de champ RF, les utilisateurs peuvent sur l'exposition aux radiofréquences et la conformité d'acquiescer les informations correspondante. This Class B digital apparatus complies with Canadian ICES-003.

Cet appareil numérique de la classe B est conforme à la norme NMB-003 du Canada. CAN ICES-3 (B)/NMB-3(B)

Limited Warranty

Smacircle provides with each Smacircle S1 a "Smacircle Limited Warranty." This is the only warranty applicable to the Smacircle S1. Consult the "Smacircle Limited Warranty" delivered with your Smacircle S1 and on APP for the specific terms of limited warranty coverage.

Warranty Information

Smacircle offers a ONE YEAR limited warranty covering the hardware of Smacircle S1 ("Product"). This warranty gives you specific legal rights and you may also have other rights which vary from country to country. Smacircle warrants Smacircle S1 ("Product") to be free from defects in materials and workmanship under normal use for one year from the point of export from our factory. If a hardware defect arises and a valid claim is received within the warranty period, at its option and to the extent permitted by law, Smacircle will: (1) repair the hardware defect by using new or refurbished parts that are equivalent to new in performance and reliability; (2) exchange the product with a product that is new or refurbished, that is substantially equivalent to the original product. This warranty is for replacement for like-items only and does not cover items out of production if the company no longer stocks

them. This warranty is not assignable or transferable. When a product or part is exchanged, any replacement item becomes your property and the replaced item becomes SMACIRCLE Product. Disassembling the Product will void this warranty. Only Smacircle should perform repair service on this product. Important: DO NOT disassemble the product or any part of it. This warranty only covers technical hardware defectiveness during the warranty period and under normal use conditions. Smacircle does not warrant uninterrupted or error-free operation of this Product. This warranty does not apply to damages or circumstances, such as, but not limited to: (a) Damage that is caused by conditions, malfunctions, or damage not resulting from defects in material or workmanship. These conditions include, but are not limited to, road hazards, accidents, and improper operation or maintenance; (b) Product has been tampered with, repaired and/or modified by non-authorized personnel; (c) Obsolescence; (d) Damage (accidental or other) to the Product that is cosmetic, meaning damage that does not impact the operation and functioning of the Product; such as rust, change in color, texture or finish; wear and tear, scrapes, scratches, dents, cracks, or gradual deterioration; (e) Damage to the product caused by war, terrorism, fire, accident, natural disaster, intentional or accidental misuse, abuse, neglect or improper maintenance, use under abnormal conditions, accidental drops, or fire; (f) Damage to the Product caused by an external electrical fault, surge, or any electrical anomaly; (g) Any contamination, condition or other circumstance, which Smacircle, in its sole discretion, considers a danger to health and safety; including, but not limited to any contact between the Product and a biohazard, bodily fluids, infectious materials/substance, chemicals, hazardous substances, diseases, radiation, or other; (h) Fraud, theft, misplacement, unexplained disappearance, or willful acts.

Disclaimers

Neither Smacircle LMT Ltd. nor any of our affiliates warrants the accuracy or completeness of the information, products, or services provided by or through this Manual, which are provided "as is" and without any express or implied warranties of any kind, including warranties of merchant-ability, fitness for a particular purpose, or non-infringement of intellectual property. To the fullest extent permissible by the applicable law, we hereby disclaim all liability for product defect or failure or for claims that are due to normal wear, product misuse or abuse, product modification, improper product selection, noncompliance with any codes, or misappropriation. To the fullest extent permissible by the applicable law, we hereby disclaim any and all responsibility, risk, liability, and damages arising from death or personal injury resulting from assembly or operation of our products. Smacircle assumes no responsibility, nor will be liable, for any damages to, or any viruses or malware that may infect your computer, telecommunication equipment, or other property caused by or arising from your downloading of any information or materials related to Smacircle products.

ENJOY!